



# TeSys VLS Disconnect Switches

# Agenda- TeSys VLS



Introduction

Features and Benefits

Selection & Resources

# TeSys VLS Disconnect Switches



UL 98 disconnect



UL 60947-4-1 disconnect

## Product

The TeSys VLS disconnect switches are the newest non-fused disconnect offer to the TeSys family.

- Available 16 to 60 A (UL 60947-4-1) and 60 to 100 A (UL 98)
- DIN/panel mount or front mount
- Unique features that increase reliability
- Full compliment of disconnect accessories

## Unique value

The TeSys VLS disconnect switches are ideal for OEMs and panelbuilders.

- Compact size to reduce panel space requirements
- Easy-to-turn handle - improvement over competitor design
- Improved grip on DIN rail prevents sliding/misalignment
- Snap on accessories
- Competitively priced

# TeSys VLS Disconnect Switches

TeSys VLS disconnects offer both types

## UL 98 rated disconnects

Used above the branch short circuit protective device.



63 to 125 amps IEC  
60 to 100 amps UL

40 to 60 HP 480V UL

DIN rail, panel mount version  
Door mount version

## UL 60947-4-1 rated disconnects

Used below the branch short circuit protective device.



16 to 63 amps IEC  
16 to 60 amps UL

10 to 30 HP 480V UL

DIN rail, panel mount version  
Door mount version

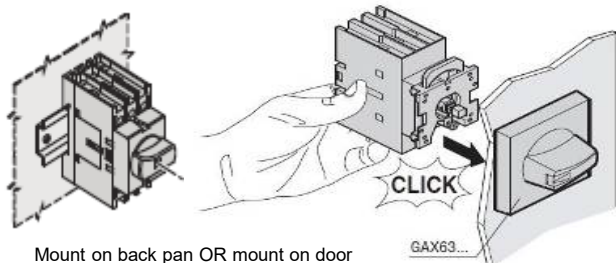

Mount on back pan OR mount on door

GAX63...

Internal

Life Is On

Schneider  
Electric

# A Closer Look at UL Standards for Disconnect Switches

Which UL standard applies?



TeSys VLS  
UL 98 Disconnect

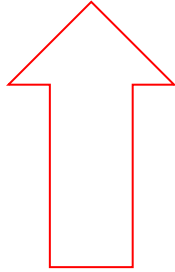

Use **UL 98** rated disconnects above the branch short circuit protective device.



TeSys VLS  
UL 60947-4-1  
Disconnect

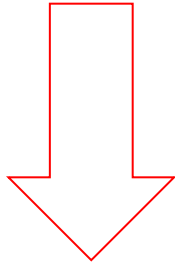

Use **UL 60947-4-1** (formerly 508) rated disconnects below the branch short circuit protective device.

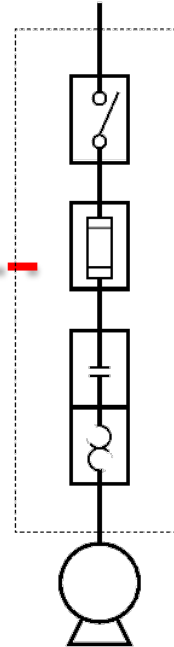

Branch short-circuit  
protective device

# TeSys VLS Disconnects - Product Overview



## Compact Size

The three-pole 16–63 A disconnect switches are made up of a single unit body, a mere 36 mm (1.4 in.) wide, while those rated 63–125 A are only 70 mm (2.8 in.) wide.

## Accessory Flexibility

Mounting and removal of the fourth pole and add-on blocks are simple and quick operations with no need for tools.

## Certifications

All VLS disconnect switches are certified by cCSAus and are UL Listed for Canada and USA. The 16–63 A types are certified according to UL60947-4-1/CSA 22.2 n° 60947-4-1-14 while the 63–125 A types to UL98/CSA 22.2 n° 4 standards.



# TeSys VLS Disconnects - Accessories



## Side Mount Add-on Fourth Pole

Simultaneous or early-make contact operation of the fourth pole with respect to the disconnect switch poles.

## Add-on Auxiliary Contacts

One add-on block suitable for use with all eight ratings of disconnect switches, having simultaneous operation with the switch poles. Includes versions with an early-break NO contact.



Internal

Life Is On

Schneider  
Electric

# TeSys VLS Disconnects – Improved Handle Design



## Handles are **included as standard**

Some disconnects do not include handles. TeSys VLS disconnects include a handle as standard.

## Handles are **easy to turn**

Some disconnect handles require significant effort to operate. TeSys VLS disconnects are noticeably easier to operate.

## IP65 **Padlockable** Handles

Offers a wide range of selector or pistol grip handles, with screw or ring (hole) mounting. All handles are equipped with a built-in padlockable mechanism.

VLSH2H5R selector handles snap onto the 16–40 A door-mounting disconnect switches with no need for tools.

# TeSys VLS Disconnects – Improved External Handles

## Handle Adapability

The predrilled mounting holes in the front handle plate make it easier to replace disconnect switches in the field without additional drilling.



## External Handle Features

- NEMA 1, 12, 3R, 4, 4X
- Red/Yellow or Black

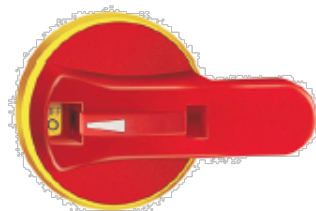

## Defeatable UL60947-4-1 Handle Version

UL60947-4-1 standards require internal panel inspection by authorized personnel, with power applied. For rear mounting devices, selector and lever handles are available with a UL60947-4-1 feature as part of the operating handle, to provide a defeat function when the disconnect switch is closed (that is, in the On position).

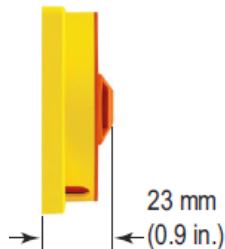

## Reduced Handle Thickness

VLSH1S5R and VLSH1S5B handles are only 23 mm (0.9 in.) thick.

## Switch Status Indication

The open or closed state of the switch is clearly visible at a distance thanks to the simple and modern design of the handle.

# TeSys VLS Disconnects – Improved Mounting

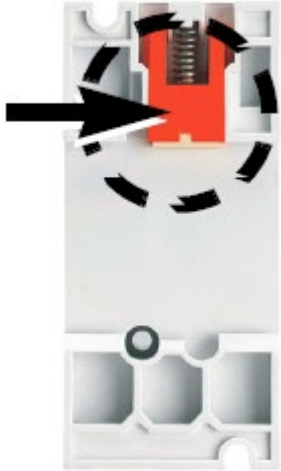

## Slide-Resistant Rubber Insert

A rubber insert helps **prevent** the disconnect switches from **sliding** on the DIN rail, even when they are out of tolerance or mounted vertically.

## Mount to Door **Without Tools**

Simple and easy to mount door disconnect requires no tools. Just a simple click.

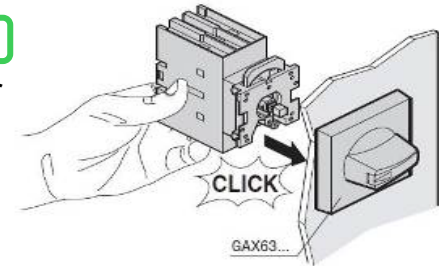

# TeSys VLS Disconnects – Unique Accessories



## 6 and 8 Pole Version

A mechanical coupling system is available for the 16–125 A disconnect switches for DIN rail mounting, to allow for 6- or 8-pole disconnectors, along with a mechanical interlock mechanism for the line changeover function (I – O – II).



## Fuse Holders

A three-pole fuse holder can be added to 16–32 A disconnect switches for DIN rail mounting, to provide a single compact unit. The fuse can be accessed only when the disconnect is in the Off position. Fuses: UL listed, 30 A, Class CC.

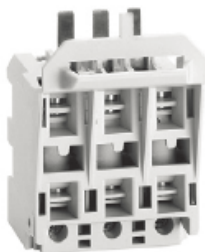

# Dimensions

Compact size makes TeSys VLS disconnects ideal for tight spaces

## 16 to 63 amp UL 60947-4-1 disconnects

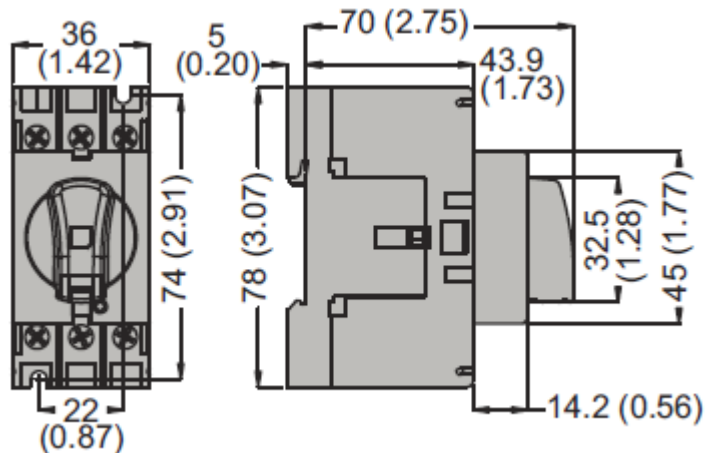

Dim. = mm (in.)

## 63 to 125 amp UL 98 disconnects

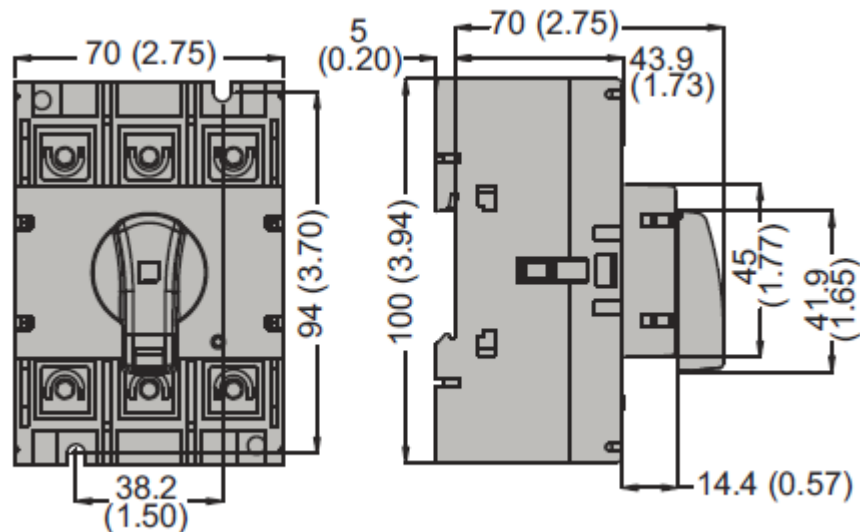

Life Is On

Schneider  
Electric

# Part Number Explanation

## Interpreting the Catalog Number

Some combinations are not available. Use only for interpreting the catalog number.

Example	VLS	3P	016	R	1
<b>Description</b>	Disconnect switch	1P= 1 pole 3P = 3 poles	016 = 16 A    063 = 63 A 025 = 25 A    080 = 80 A 032 = 32 A    100 = 100 A 040 = 40 A    125 = 125 A	D = Door mounting R = DIN rail mounting	1 = Small size (16–63 A), UL508 2 = Large size (63–125 A), UL98

Example	VLSH	2	S	5	R
<b>Description</b>	Rotary handle	1 = Recessed, 65 x 65 mm 2 = Protruding, 65 x 65 mm 3 = Pistol grip, 75 mm dia. 4 = Protruding, 48 x 48 mm	H = Hole fixing S = Screw mounting	5 = 5 mm shaft opening 7 = 7 mm shaft opening	B = Black BC = Black, changeover BD = Black, defeatable R = Red RD = Red, defeatable

# Resources

## Ordering information

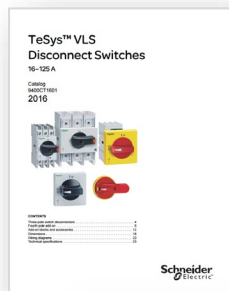

[Catalog 9400CT1601](#)

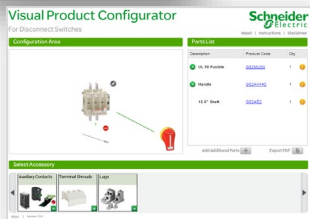

[Product Configurator](#)

## Videos



[Discover to TeSys VLS](#)

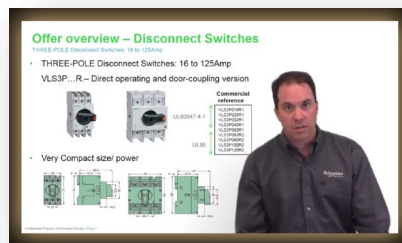

[Training](#)

## Additional Information



[Handout 3150HO1602](#)

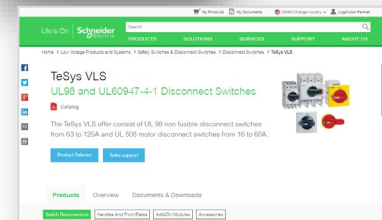

[Website](#)

## Additional Support

Steve Natale

Sr. Product Manager

[Steve.Natale@schneider-electric.com](mailto:Steve.Natale@schneider-electric.com)

Phone: 919-217-6746 X-76746

Erik Barnes

Offer Marketing Manager

[Erik.Barnes@schneider-electric.com](mailto:Erik.Barnes@schneider-electric.com)

Phone: 919-480-7126

Life Is On

Schneider  
Electric

# Thank you

Life Is n

Life Is n

**Schneider**  
Electric