

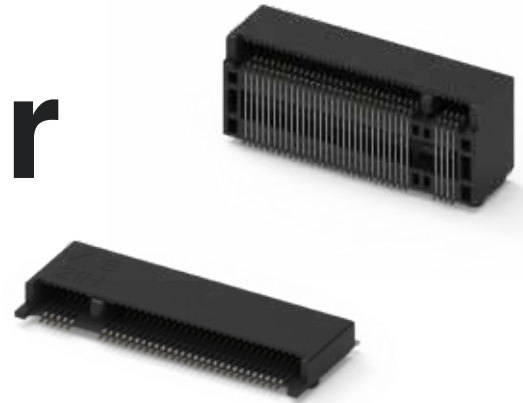

M.2 Connector NGFF

High-speed data transmission that supports PCI Express 3.0, SATA 3.0 and USB 3.0



M.2 connector, also known as the Next Generation Form Factor (NGFF) is originally designed for the ultra-thin products. Its compact size could save over 20% of PCB design space compare with mini PCIe connector. M.2 connector applies to high-speed data transmission that supports PCI Express 3.0, SATA 3.0 and USB 3.0.

APPLICATION

Type	A Key	B Key	E Key	M Key
Module Card Type	1630,2230,3030	3042,2230,2242,2260,2280,22110	1630,2230,3030	2242,2260,2280,22110
Applications	Wireless Connectivity devices including combinations of Wi-Fi,BT, HFC, and/or WiGig	SSD or WWAN + GNSS (2G GSM, GPRS, 3G, CDMA,WLAN, WWLAN, HSPA MODEM,GPS, 4G WiMAX)	Wireless Connectivity devices including combinations of Wi-Fi,BT, NFC, and/or GNSS	SSD devices and Host I/Fs supported are PCIe with up to four lanes or SATA





Two Heights To Check

- Dim. A: The heights are between min- 2.1mm to max- 8.5mm.
- Dim. B: For double-sided modules, this height is also important to keep in mind.

Quick Click

- M.2 Latch is New Launch to replace screw.
- ATTEND “Click” Solution allows you to assemble the PCB module without screw driver less than 1 second.

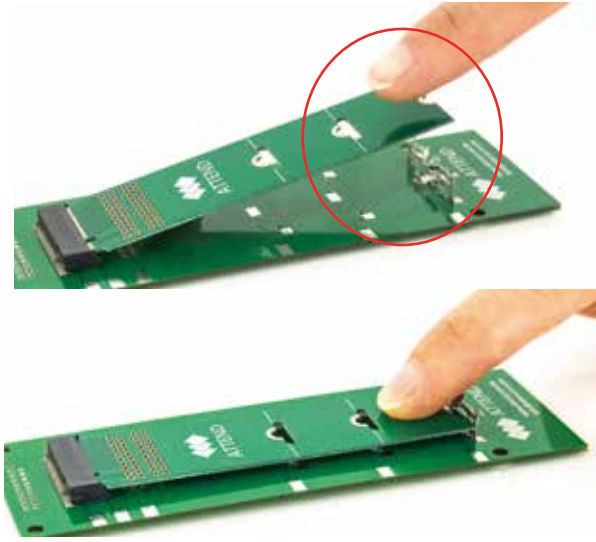

Time and Labor cost saving

Less than 1 second for assembly.

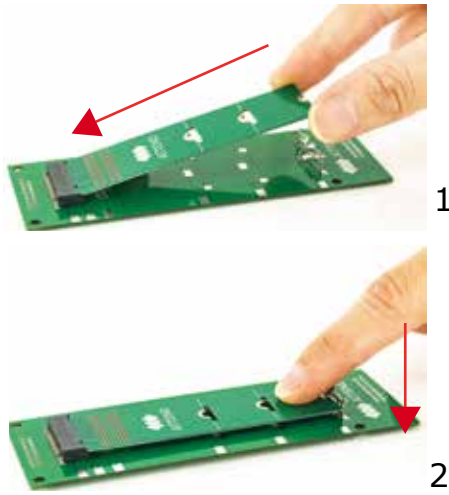

No screw driver needed.



Easily disassembly.

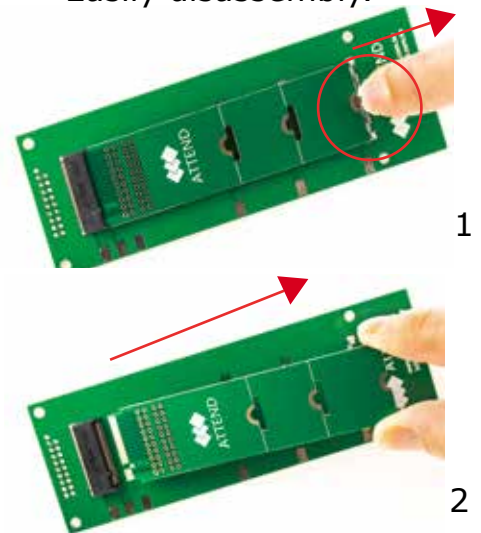

A Key



123A-21A00, H=2.1mm
123A-30A00, H=3.0mm
123A-40A00, H=4.0mm
123A-85AA0, H=8.5mm

B Key



123A-21B00, H=2.1mm
123A-30B00, H=3.0mm
123A-40B00, H=4.0mm
123A-58B01, H=5.8mm
123A-85BA0, H=8.5mm

E Key



123A-21E00, H=2.1mm
123A-30E00, H=3.0mm
123A-40E00, H=4.0mm
123A-58E01, H=5.8mm
123A-85EA0, H=8.5mm

M Key



123A-21M00, H=2.1mm
123A-30M00, H=3.0mm
123A-40M00, H=4.0mm
123A-58M01, H=5.8mm
123A-85MA0, H=8.5mm



M.2 Latch
H=3.0mm
H=4.0mm
H=5.8mm